



# FICHA TÉCNICA



## QWCD35

Marca: **QLIGHT**

Qlight innovación en alarmas y señales para mejorar la eficiencia y la seguridad laboral.

**Qlight**



## QWCD Series

- LED Strobe Signal Light and Electric Horn Combinations
- A new concept of using the horn cover as a light globe



**QWCD series is a patented product with an integrated horn and light globe.**  
(Patent registration : 10-1452447 horn having a light emitting part)

QWCD series	
QWCD35	Built-in standard sound
QWCD35SD	MP3(SD Card)
QWCD50	Built-in standard sound, large output sound
QWCD50SD	SD Card(MP3). Large output sound

- By using the horn cover as a light globe, the size of the product has been reduced significantly
- The color of light can be selected from red, yellow, green, or blue
- Product has two models : the basic model with 31 built-in sounds, and an external sound (MP3) type model
- Includes seven different playback functions; one function is the continuous playback function which provides constant message notification
- There are 31 built-in sounds that can be played in various environments, and supports a Binary input method
- You can save and play up to 31 mp3 files using an external SD Card
- Can easily set up the sounds using a PC
- By making the horn cover with polycarbonate (PC) material, The product has excellent durability and weather resistance
- Can be used for heavy-duty, ship, or outdoor use which requires waterproof, dustproof structure (IP66)

### Built-in sound type

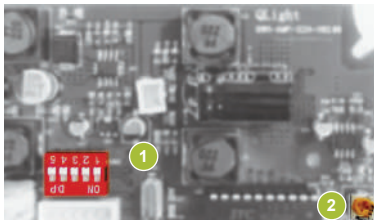

- 1 Sound selection switch
- 2 Volume

### The input method of built-in sound type

	1	2	3	4	5
No.	1	2	3	4	5
0	0	0	0	0	0
1	0	0	0	0	1
2	0	0	0	1	0
:	:	:	:	:	:
31	1	1	1	1	1

Built-in sound type model supports Binary input mode which provides a selection of 31 different input combinations for five kinds of sounds.

You can only select 2 numbers with 1 switch; "0", "1". With 5 switches you can have 31 combinations. Selecting one sound from 5 switches is the Binary input method.

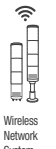

### SD Card(MP3) type

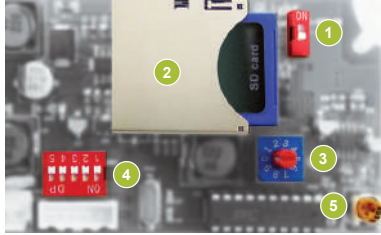

- 1 Sound setting switch
- 2 MP3 playable SD Card
- 3 Play mode setting switch
- 4 Sound select switch
- 5 Volume

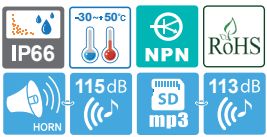

- Qlight's exclusive innovative design - the horn cover emits light!
- Combination of 31 sound options built in and SD Card(MP3) option



### The sound selection method of SD Card type

Can easily select built-in sound or external sound(MP3) by using the sound selection switch.

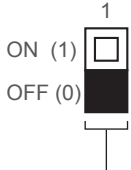

**The sound selection**  
 0 : Select built-in sound  
 1 : Select SD Card

- 31 built-in special warning sounds
- Supports SD Card (MP3)
- Binary Input : 31Ch
- Bit Input : 5Ch (SD Card only)
- A multifunctional product that can play MP3 files using an SD Card
- Please refer to page 26 for detailed settings
- Built-in sound is set to #1 as default

### Common Specifications(QWCD35/ QWCD35SD/ QWCD50/ QWCD50SD)

- Easy device customization with built in sound selection function, volume adjustment function and an SD Card slot for user inputted tones
- 31 available tones that can be selected for a variety of environments
- The user can select their own tones by inputting the MP3 file directly into the SD Card
- 31 pre-recorded tones available via binary input
- Suitable for use in environments that require a tight seal and superior dust protection rated IP66
- Flashing rate : 60-80 flashes/min(steady/flashing mode selection available in built in switch)
- Materials : Horn-PC, Body-PC+ABS
- Ambient operating temperature : -50°C to +60°C(Standard type)  
 -20°C to +50°C(SD Card type)
- Protection Rating : IP66
- Certificates : CE Compliant, UL Listed
- Compliant with RoHS directive

### QWCD35 LED Strobe Signal Light and Electric Horn Combination

Model number	Voltage	Current	Sound Pattern and Volume	Certificates	Weight	Color
QWCD35 Built-in standard sound	DC12V-24V	Max 1.30A	• Bit Input : 5Ch (SD Card) • Binary Input : 31Ch	CE DC Only	1.10kg	• R-Red • A-Amber
QWCD35SD MP3	AC110V-220V	Max 0.31A	• Warning Sounds: 115dB • MP3 Messages : 113dB	UL DC Only	1.15kg	• G-Green • B-Blue

DC type model has a free-voltage range of 10V-30V.  
 AC type model has a free-voltage range of 100V-240V.

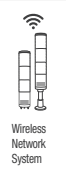
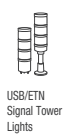
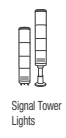



QWCD35 series

**Technical Diagram** (Units : mm)

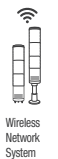
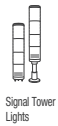
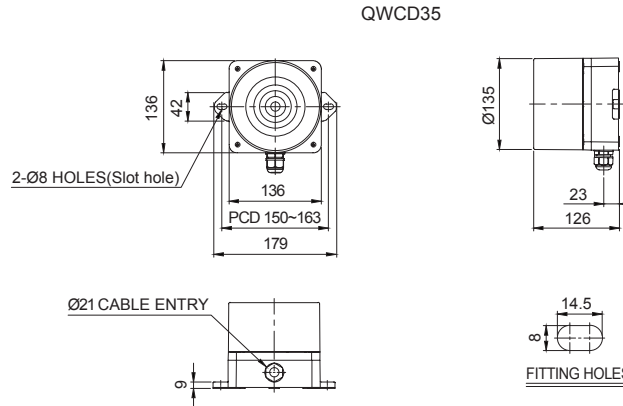

**Customization**

- External signal line available for users to connect their own sound input (Model number : -LC)

**Ordering Specification**

<b>QWCD35</b> [Model number]	-	<b>110/220</b> [Voltage]	-	<b>R</b> [Color]	-	<b>LC</b> [sound selection]
<ul style="list-style-type: none"> <li>• QWCD35</li> <li>• QWCD35SD</li> </ul>		<ul style="list-style-type: none"> <li>• 12/24 -DC12V-24V</li> <li>• 110/220 -AC110V-220V</li> </ul>		<ul style="list-style-type: none"> <li>• R-Red</li> <li>• A-Amber</li> <li>• G-Green</li> <li>• B-Blue</li> </ul>		<ul style="list-style-type: none"> <li>• Standard</li> <li>-Built-in switch</li> <li>• LC</li> <li>-External contact</li> </ul>

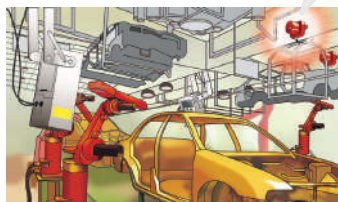

QWCD35 model applied in an automobile production plant environment.

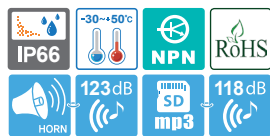

•Qlight's exclusive innovative design - the horn cover emits light!

•Combination of 31 sound options built in and SD Card(MP3) option

**QWCD50 LED Strobe Light and Electric Horn Combination**

Model number	Voltage	Current	Sound Pattern and Volume	Certificates	Weight	Color
QWCD50 Built-in standard sound	DC12V-24V	6.4A	<ul style="list-style-type: none"> <li>• Bit Input : 5Ch (SD Card)</li> <li>• Binary Input : 31Ch</li> <li>• Warning Sounds : 123dB</li> </ul>		2.7kg	<ul style="list-style-type: none"> <li>• R-Red</li> <li>• A-Amber</li> <li>• G-Green</li> <li>• B-Blue</li> </ul>
	AC110V-220V	0.32A			2.7kg	
QWCD50SD MP3	AC110V-220V	Max 0.600A	<ul style="list-style-type: none"> <li>• MP3 Messages : 118dB</li> </ul>		3.0kg	

AC type model has a free-voltage range of 100V-240V.





## Technical Diagram

(Units : mm)

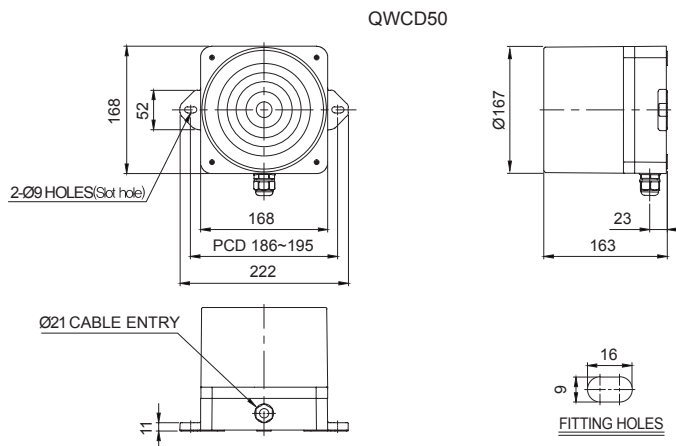

Warning/  
Signal/  
Stackable



Signal &  
Electric Horn/  
Speakers



Vessels and  
Heavy-Duty  
Equipment



Explosion  
Proof



Warning  
Light Bar



Aviation  
Obstruction  
Lights



Signal Tower  
Lights



USB/ETN  
Signal Tower  
Lights



Wireless  
Network  
System



Electric Horn/  
Speakers



Industrial  
LED Lights



## Wiring Instructions

- Standard specification : Use internal switches
- Customization : Use external contact



QWCD50 series

### QWCD-DC/AC

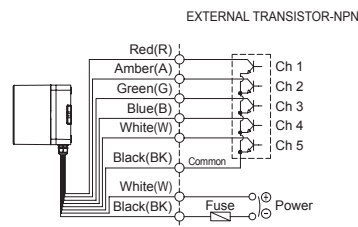
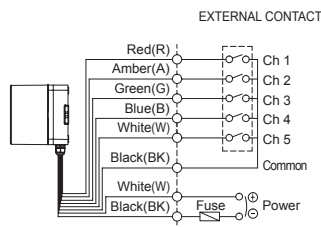

- Wiring to external contact and transistor
- Wiring to transistor, use the NPN transistor
- Power line standard UL1015 AWG18(0.75sq)×2C 400mm
- Signal line standard UL1007 AWG22(0.3sq) 400mm
- DC type : Black output line is negative(-)
- Channel selection : Bit input, 5 sound tones for each group
- Binary input 31 sound tones output

\* Please refer to Page 26 for set of channel input.  
(If wiring is changed by channel selection switch)



## Customization

- External sound selection line  
(Model number : -LC)



## Ordering Specification

<b>QWCD50</b> [Model number]	-	<b>110/220</b> [Voltage]	-	<b>R</b> [Color]	-	<b>LC</b> [sound selection]
<ul style="list-style-type: none"> <li>• QWCD50</li> <li>• QWCD50SD</li> </ul>		<ul style="list-style-type: none"> <li>• 12-DC12V</li> <li>• 24-DC24V</li> <li>• 110/220</li> <li>• -AC110V-220V</li> </ul>		<ul style="list-style-type: none"> <li>• R-Red</li> <li>• A-Amber</li> <li>• G-Green</li> <li>• B-Blue</li> </ul>		<ul style="list-style-type: none"> <li>• Standard</li> <li>-Built-in switch</li> <li>• LC</li> <li>-External contact</li> </ul>